



This guide is to assist in selecting and replacing a motor for a Intermatic Timer ONLY. Although the procedure may be similar to other brands, the replacement parts are not interchangeable.

From time to time, as a timer ages, the motor that drives the clock can fail. As this happens, you may have the option to replace just the motor, instead of the entire timer unit. This guide will assist in determining if the motor is in need of potential replacement, and direct you to a suitable replacement.



The first step in determining if the motor is in need of potential replacement is to ensure the timer has power applied. This may be confirmed by ensuring the circuit breaker is “on”, or by checking with a multi-meter.

Next, check if the timer motor is operating. By looking through the little “window” in the top right corner of the time wheel, you should be able to see the timer motor and gears. If they are not moving, and power is applied, then you may need a new motor. If they are moving, then the motor is fine and motor replacement will not correct the situation.

In order to replace the motor, you will need to determine the proper motor number. To do this, you will need to disconnect the power and remove the timer mechanism from the case by depressing the retainer clip, and tilt the mechanism forward. It will then slide up allowing it to be removed. You may want to remove any wires from the timer first, for ease of removal. Be sure to mark the wires with the terminal numbers, so that re-installation will be easier.

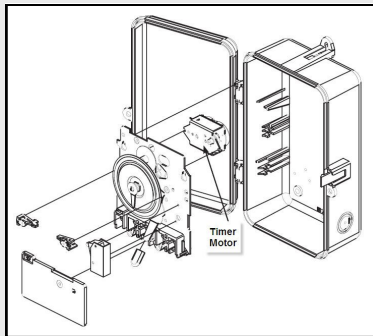
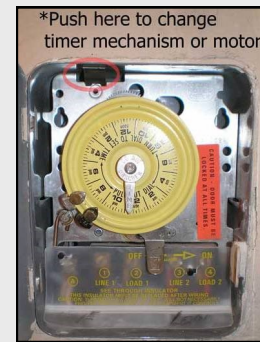

The timer motor is located on the backside of the mechanism and is held in place by a few screws. There are usually 2 wires that go around to the front side to the terminals to provide power to the motor. Remove the wires and motor from the mechanism for replacement.

On the backside of the motor there will be a part number, usually starting with a “WG” or “CW”. There may also be a suffix following a dash. This is just a revision number and is not critical in selecting the new motor.

This number is the motor number to be used for the replacement. The use of any other model may have adverse effects, and the timer may not operate as intended.



To replace, just perform the above steps in reverse, test, and the timer should be operational.

Information sources include Intermatic



If you are still having difficulty choosing an Intermatic Timer Motor, please contact us at askzoro@zoro.com or 855-289-9676

Product Compliance and Suitability.

THE PRODUCT STATEMENTS CONTAINED IN THIS EZTIP ARE INTENDED FOR GENERAL INFORMATIONAL PURPOSES ONLY. SUCH PRODUCT STATEMENTS DO NOT CONSTITUTE A PRODUCT RECOMMENDATION OR REPRESENTATION AS TO THE APPROPRIATENESS, ACCURACY, COMPLETENESS, CORRECTNESS OR CURRENTNESS OF THE INFORMATION PROVIDED. INFORMATION PROVIDED IN THIS EZTIP DOES NOT REPLACE THE USE BY YOU OF ANY MANUFACTURER INSTRUCTIONS, TECHNICAL PRODUCT MANUAL OR OTHER PROFESSIONAL RESOURCE OR ADVISER AVAILABLE TO YOU. ALWAYS READ, UNDERSTAND, AND FOLLOW ALL MANUFACTURER INSTRUCTIONS.